

# 刀具管理系统 TOOL MANAGEMENT

# 目录

## CONTENT

<b>刀具管理系统/Tool Management</b>	
概论/Overview	662
<b>模块及工具柜/Modules and Cabinets</b>	
转角连接单元/Corner Module	665
装配工作台单元/Workbench Assembly Module	666
多层刀具柜 /Magazine Cabinet	668
货架单元/Shelf Module	669
通用型垂直储物柜/Vertical Cabinet Universal	670
刀柄储物柜/Vertical Cabinet Tool Holder	671
刀柄储物柜-货架/Vertical Cabinet Tool Holder – Shelves	673
<b>装配工作台及附件/Assembly Station and Accessories</b>	
装配工作台/Assembly Station	674
装配工作台附件/Accessories for Assembly Station	675
<b>连接部件/Connection Parts</b> <b>676</b>	
<b>刀柄运输车 and 附件/Tool Holder Cart and Accessories</b>	
刀柄运输车/Tool Holder Cart	677
货架/Shelves	680
刀柄运输车附件/Further Accessories for Tool Holder Cart	681
<b>开孔板/Perforated Plate</b>	
开孔板下支架/Holder Jowls for Perforated Plate	682
<b>附件/Accessories</b> <b>683</b>	

# 翰默刀具管理系统-概论

## HAIMER TOOL MANAGEMENT LOGISTICS SYSTEM – OVERVIEW

带穿孔墙的角落连接单元  
Corner module with perforated wall

超级增强型热缩机的连接部件  
Connection part shrink fit machine  
Power Clamp Premium Plus

对刀动平衡一体机的连接部件  
Connection part measuring and balancing system Tool Dynamic Preset

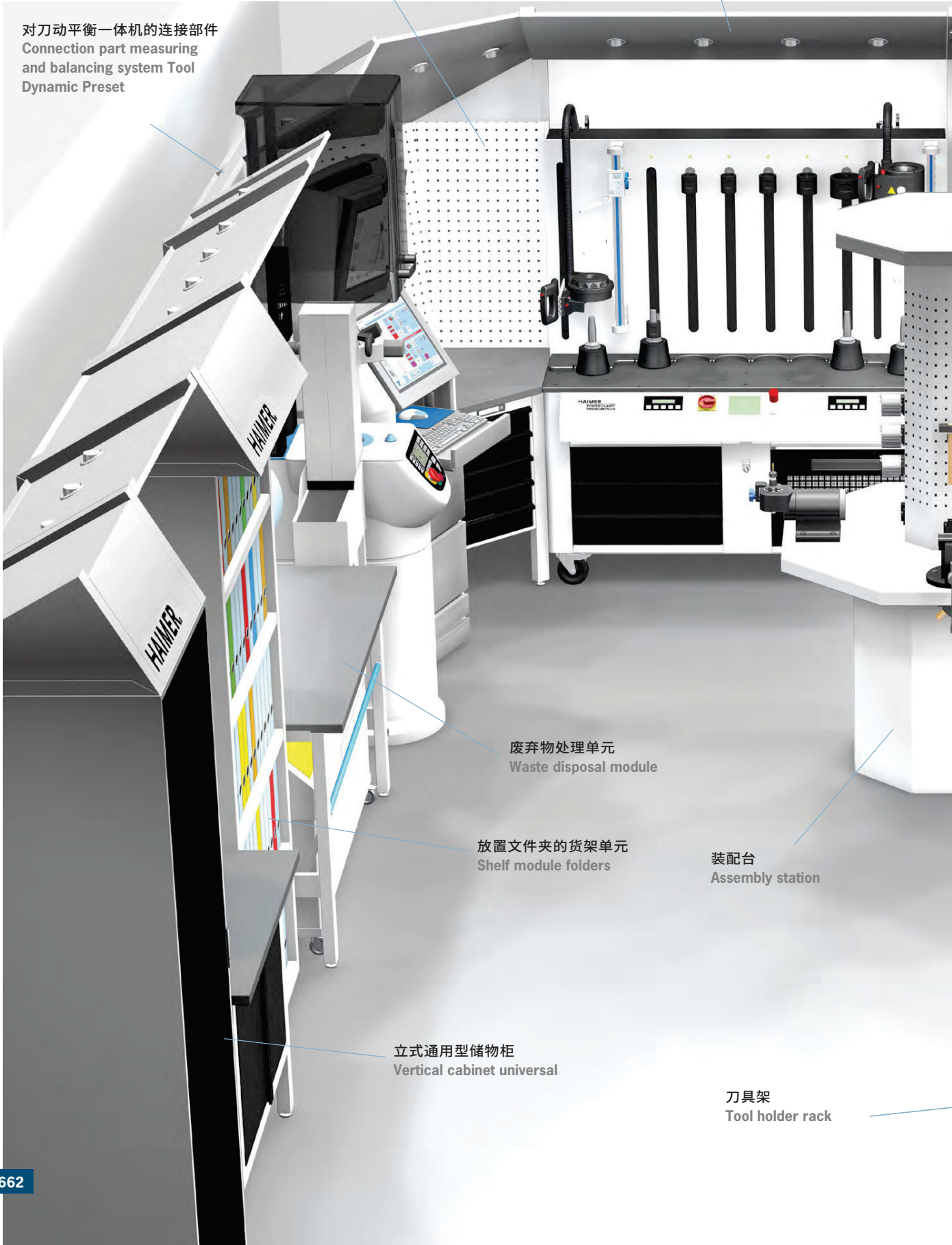

废弃物处理单元  
Waste disposal module

放置文件夹的货架单元  
Shelf module folders

装配台  
Assembly station

立式通用型储物柜  
Vertical cabinet universal

刀具架  
Tool holder rack

装配工作台单元  
Workbench assembly module

带背墙的转角连接单元, 背墙上同时含有刀具储存套  
Corner module with rear wall for storing collets and tools

信息登记工作台单元  
Workbench info module

架子部件单元  
Shelf module parts

多层刀具柜  
Magazine cabinet

立式刀柄储藏柜  
Vertical cabinet tool holders



## 刀具管理系统-工作效率更高 TOOL MANAGEMENT – FOR EFFICIENT WORKING



### 用途:

翰默刀具管理系统完善了翰默的产品范围,使其成为刀具夹持领域的系统供应商。翰默成为提供完整的刀具管理设备的单一供应商。作为刀具预调和刀具管理的完整解决方案,翰默刀具管理系统为您的工作场所提供符合人体工程学的功能标准。翰默的解决方案帮您优化和简化刀具的存储,调整和管理,因此可以保证高效率的工作。

- 根据客户的需求定制模块化的刀具室
- 其中已经具备了刀具的热缩安装、预调和动平衡的功能
- 整洁和独立的空间有助于专注的工作

### Use:

The HAIMER Tool Management completes the HAIMER product program as a system partner around tool clamping. That means HAIMER offers the complete Tool Management equipment from a single source. As a complete solution for tool presetting and tool management, the HAIMER Tool Management provides you with functional and ergonomic criteria for the design of work stations. The storage, setup and management of tools is simplified and optimised by the HAIMER solutions so that efficient working is guaranteed.

- Modular room design according to the customer's requirements
- Shrinking, balancing and presetting already integrated into the concept
- Tidy and isolated solution for concentrated working

## 转角连接单元 CORNER MODULE

### 带穿孔墙的转角连接单元 Corner module with perforated wall

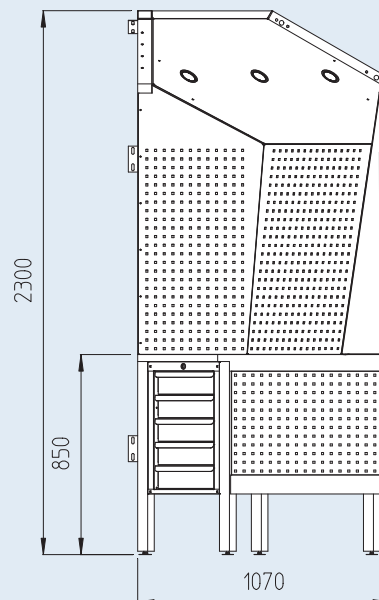
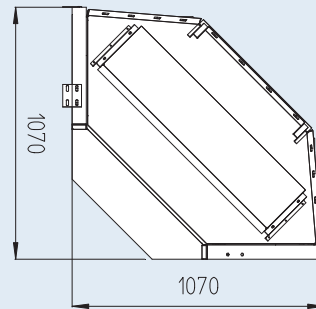

#### 用途:

穿孔的后壁以及抽屉单元提供了一个整洁及结构化的工作空间。三个集成的LED灯保障了一个持续明亮和舒适的工作氛围。

#### 发货时包含:

- 带穿孔墙的转角连接单元, 集成了LED灯以及相应的抽屉单元

#### Use:

The perforated back wall and drawer unit provide a clean and structured workspace. The three integrated LED spots ensure a continually bright and comfortable working atmosphere.

#### Delivery includes:

- Corner module with a perforated wall, roof with LED lighting, drawer unit

#### 描述/Description

转角连接单元 4.0/Corner module 4.0

#### 订货号/Order No.

84.802.00.3

## 装配工作台单元 WORKBENCH ASSEMBLY MODULE



### 用途：

- 自由配置的工作台
- 各种配置可模块化预选，根据您的选择进行对应产品的交付

### 发货时包含：

- 包含穿孔墙的标准工作台，集成了4个LED灯柱以及4个230V电源插座

### Use:

- Freely configurable workbench
- Individual delivery by using a predefined modular system

### Delivery includes:

- Standard equipment includes perforated back wall, 4 LED spots and 4 x 230V power outlets

### 描述/Description

装配工作台单元/Workbench assembly module

### 订货号/Order No.

84.801.00.3

## 装配工作台单元-配置 WORKBENCH ASSEMBLY MODULE – CONFIGURATIONS



配置/Configurations	订货号/Order No.
带穿孔墙的装配工作台单元/Workbench assembly module with perforated wall	84.801.00.3
带抽屉柜的装配工作台单元/Workbench assembly module with drawer cupboard	84.801.01.3
带电脑支架以及显示器支架的装配工作台单元/Workbench assembly module with PC holder and screen holder	84.801.02.3
带电脑支架, 显示器支架, 以及抽屉柜的装配工作台单元 Workbench assembly module with PC holder, screen holder and drawer cupboard	84.801.03.3
带擦拭纸辊筒的装配工作台单元/Workbench assembly module with paper dispenser	84.801.04.3
带抽屉柜以及擦拭纸辊筒的装配工作台单元 Workbench assembly module with drawer cupboard and paper dispenser	84.801.05.3
带抽屉柜, 擦拭纸辊筒, 电脑支架以及显示器支架的装配工作台单元 Workbench assembly module with drawer cupboard, paper dispenser, PC holder and screen holder	84.801.06.3
带废弃物处理单元的装配工作台单元/Workbench assembly module with waste disposal module	84.801.07.3
带废弃物处理单元以及擦拭纸辊筒的装配工作台单元 Workbench assembly module with waste disposal module and paper dispenser	84.801.08.3
超级型热压机专用型装配工作台单元/Workbench module – dropped for Power Clamp Premium	84.807.00.3



## 多层刀具柜 MAGAZINE CABINET

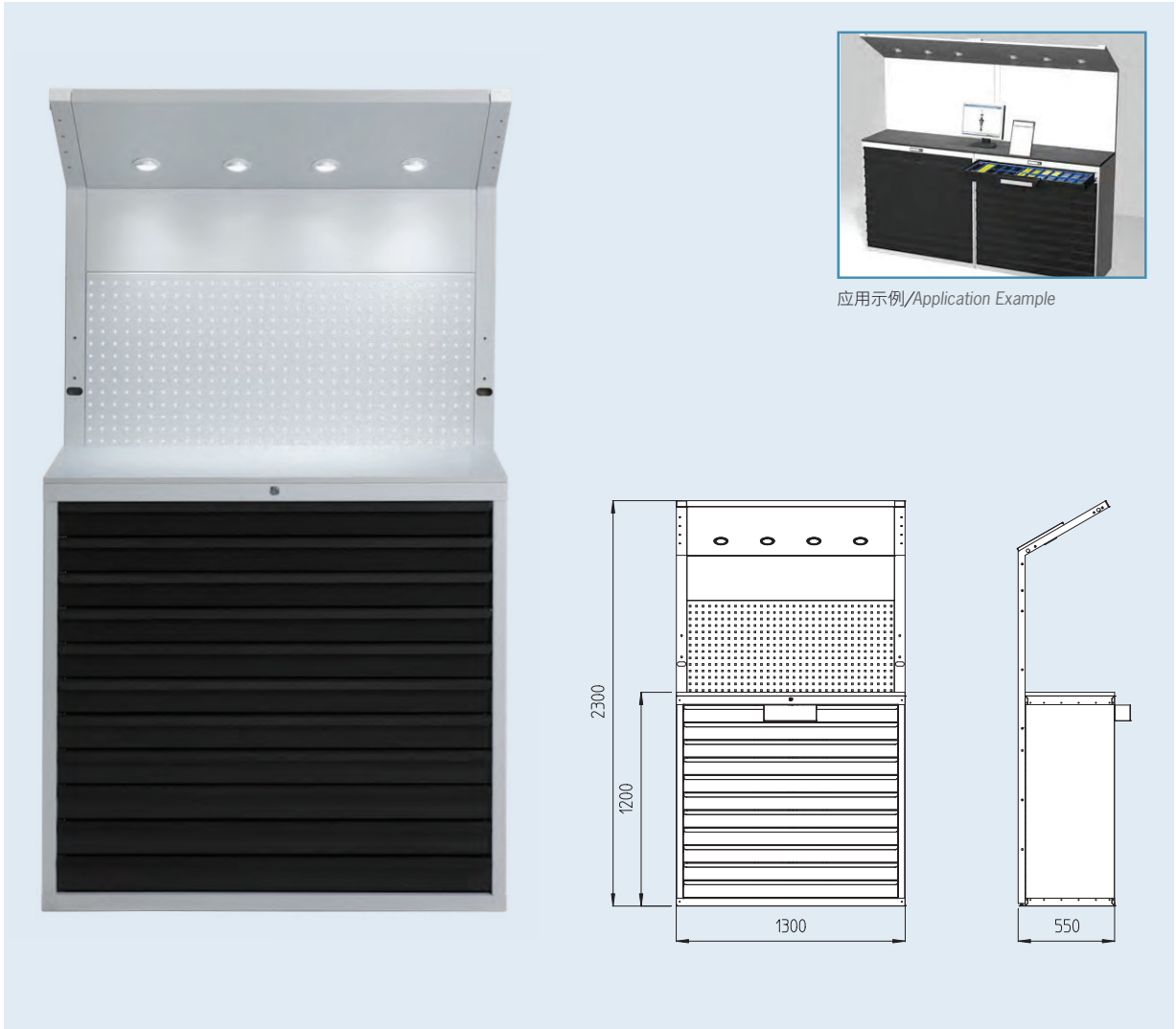

应用示例/Application Example

**用途:**

用于存储工具(刀具,刀柄等等)以及小型部件的多层刀具柜。带穿孔的背墙可以清晰的陈列各种刀具。整体高度1.2m,符合人体工程学设计。

**发货时包含:**

- 带一个标准工作台的多层刀具柜,集成了4套LED灯座的穿孔背墙
- 11个抽屉

**Use:**

Magazine cabinet for proper disposal of tools (inserts, shank tools etc.) and small parts. The perforated wall helps for a clear arrangement of (mounting) tools.

Ergonomical working height at 1,20 m.

**Delivery includes:**

- Magazine cabinet with a standing work area, perforated wall and 4 LED Spots
- 11 drawers

**描述/Description**

多层刀具柜/Magazine cabinet

**订货号/Order No.**

84.804.00.3

**附件/Accessories**

12件抽屉小组件(工业塑料,蓝色),用于多层刀具柜单层抽屉分隔

12 pcs. Drawer equipment (plastic blue) sufficient for 1 drawer at the magazine cabinet

**订货号/Order No.**

84.810.14

24个抽屉柜的分隔件(合成材料)/24 pcs. Divider for drawer equipment (synthetic material)

84.810.15

## 货架单元 SHELF MODULE

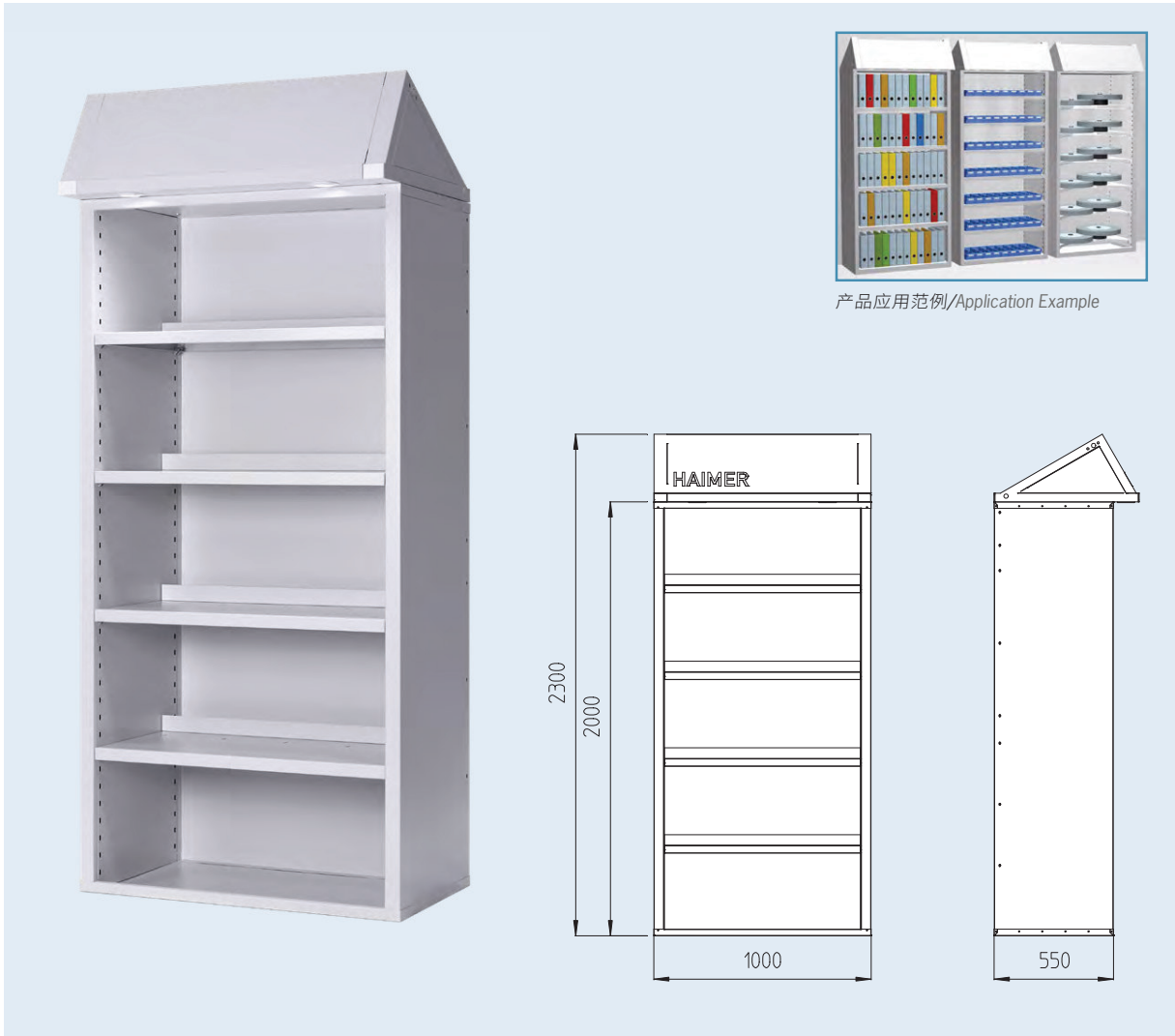

产品应用范例/Application Example

### 用途:

带遮蔽层的货架单元, 用于储放附件类产品

发货时包含:

- 标配4层货架, 以及2组LED灯座
- 选配: 额外的货架层, 砂轮货架层

### Use:

Shelf module with hood for proper disposal of accessories.

Delivery includes:

- Equipped as standard with 4 shelf cabinets and 2 LED Spots
- Optional: additional shelf cabinet, shelf cabinet for grinding wheels

### 描述/Description

带遮蔽层的货架单元/Shelf module with hood

### 订货号/Order No.

84.805.01.3

### 附件/Accessories

货架储物止动板/Shelf for shelf cabinet with stop bar

### 订货号/Order No.

84.805.00.01.3

可存储2个砂轮的砂轮用货架层/Shelf for grinding wheels for shelf cabinet to hold 2 grinding wheels

84.805.00.03.3

## 立式通用型储物柜 VERTICAL CABINET UNIVERSAL

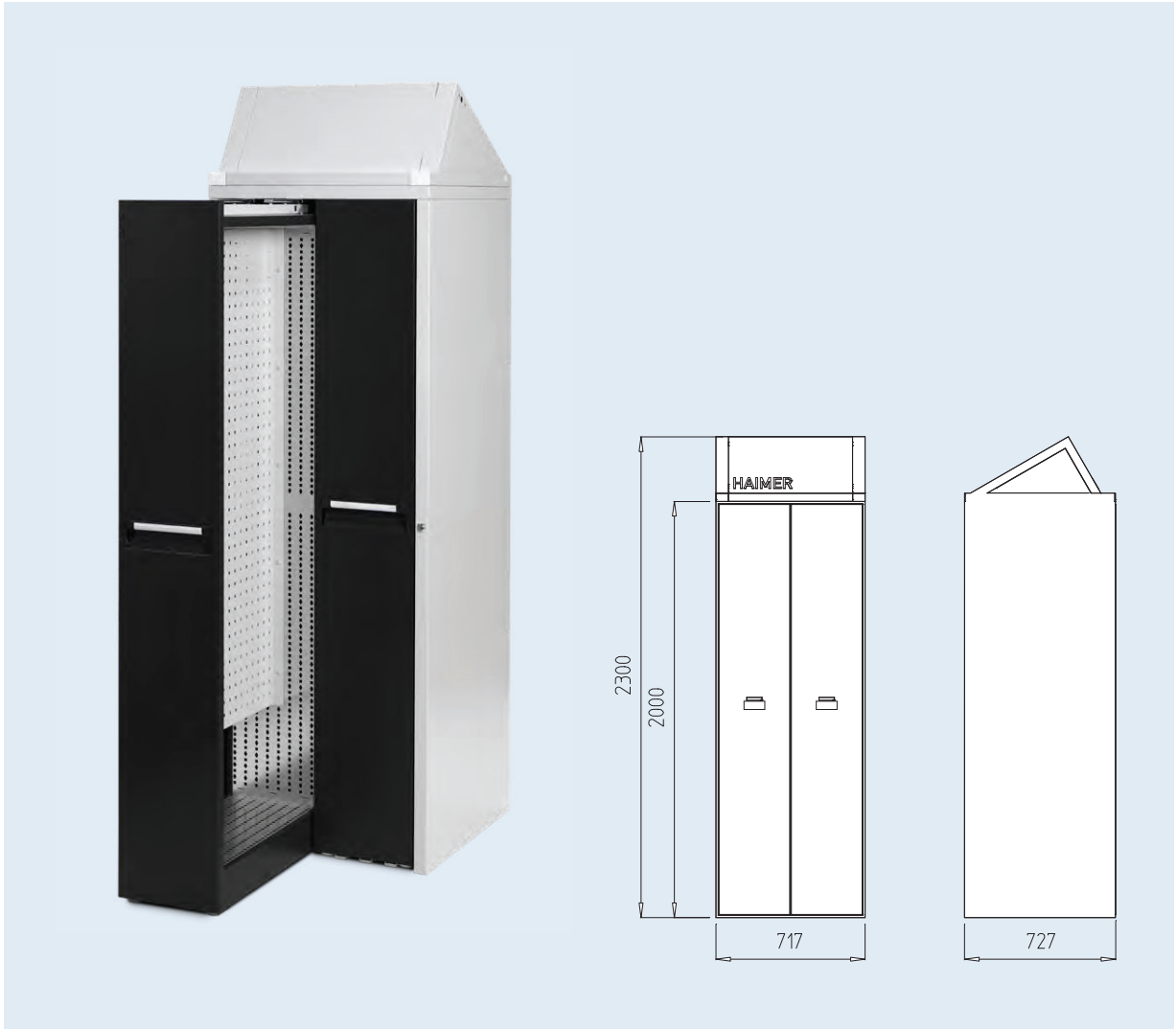

### 用途:

可两侧开出的带穿孔墙的储物柜, 便于存储刀具及刀具附件, 保持工作环境的整洁。两边都可以移动, 精准定位所需求的刀具。

### 发货时包含:

- 带两块穿孔背板的立式通用型储物柜(可两侧打开)

### Use:

Pullout cabinets with perforated walls can be equipped on both sides and provide a clean storage area for tools or auxiliary tools. The accessibility from both sides facilitates the removal and localisation of the needed tool.

### Delivery includes:

- Vertical cabinet Universal with 2 perforated panel extracts (can be equipped on both sides)

描述/Description

立式通用型储物柜/Vertical cabinet Universal

订货号/Order No.

84.805.06.3

## 立式刀柄储藏柜 VERTICAL CABINET TOOL HOLDER

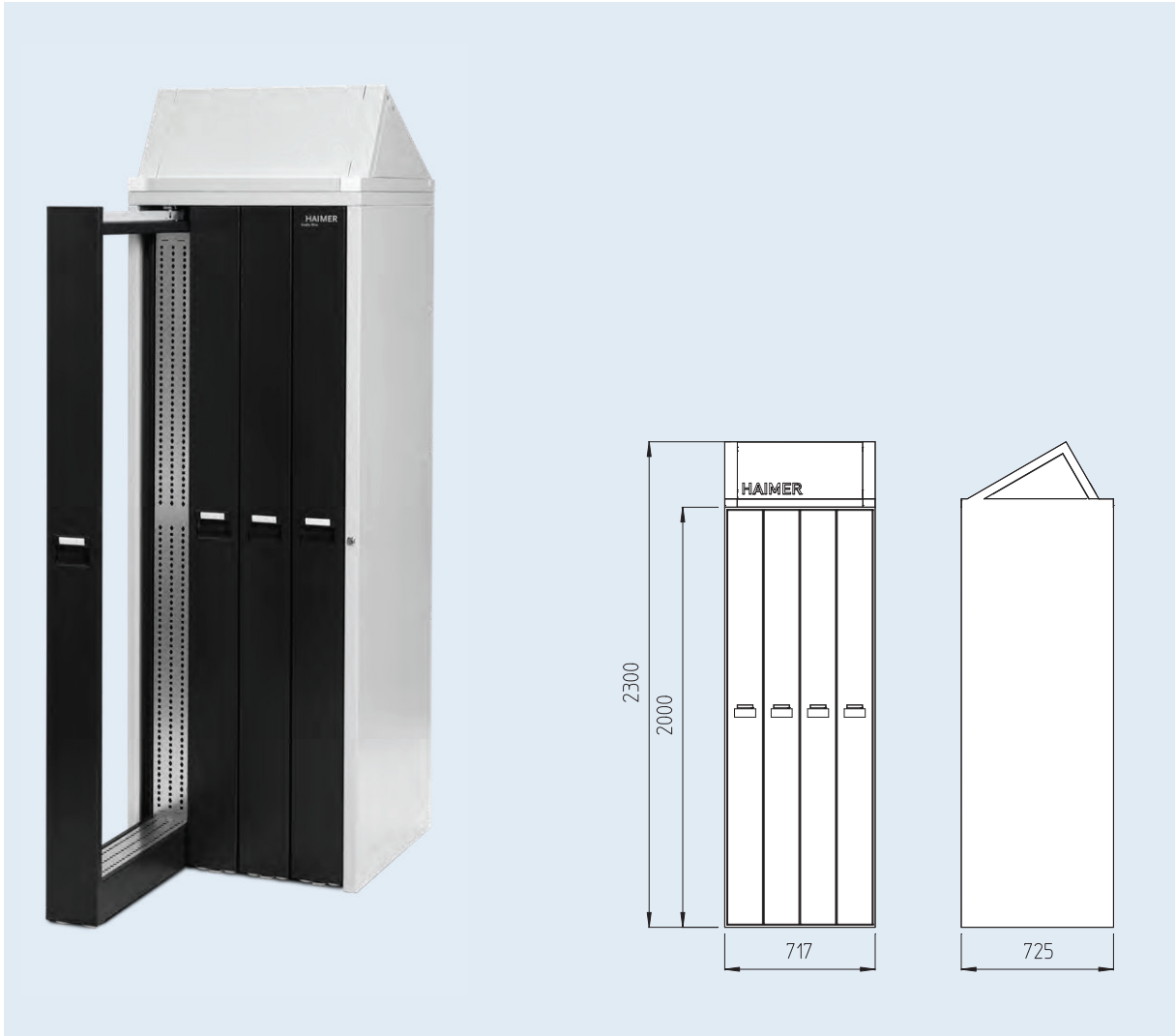

### 用途:

用于存储各种接口类型的刀柄，安全且节省空间。如有必要，也可以存放一些已经夹持了刃具的刀柄。两侧均可以打开。

### 发货时包含:

- 带4个拉柜的立式刀柄储藏柜
- 可选装的货架单元，提供了存储的安全性，维持工作环境的整洁，同时节省了存储空间

### Use:

Safe and space-saving storage of tool holders of all interfaces, if necessary with clamped cutting tools. Good accessibility from both sides of the pullouts.

### Delivery includes:

- Vertical cabinet for tool holders with 4 pullout cabinets
- Additionally available shelf units provide a clean, save and space-saving storage for your tool holders

### 描述/Description

立式刀柄储藏柜/Vertical cabinet tool holder

### 订货号/Order No.

84.805.07.3

### 附件/Accessories

立式柜专用货架/Shelves for vertical cabinet

### 订货号/Order No.

参见673页/See page 673

## 立式刀柄储藏柜产品应用范例 VERTICAL CABINET TOOL HOLDER – APPLICATION EXAMPLE

这才是正确存储您的刀柄及刀柄附件的方法  
This is how you store your tool holders and accessories correctly.



## 立式刀柄储藏柜-专用货架 VERTICAL CABINET TOOL HOLDER – SHELVES



描述/Description	订货号/Order No.
4层立式刀柄储藏柜用货架支架/Frame to hold the shelves in the 4-fold vertical cabinet	84.805.07.01
2层立式刀柄储藏柜用货架支架/Frame to hold the shelves in the 2-fold vertical cabinet	84.805.07.02
2层立式刀柄储藏柜用货架支架(加宽)/Frame to hold the shelves in the 2-fold vertical cabinet (extra wide)	84.805.07.03
<b>SK/BT/CAT储放架/Shelf SK/BT/CAT</b>	
可存放12个SK30/BT30/CAT30刀柄的储放架/Shelf to hold 12 SK30/BT30/CAT30 holders	84.805.07.032
可存放4个SK40/BT40/CAT40刀柄的储放架/Shelf to hold 4 SK40/BT40/CAT40 holders	84.805.07.040
可存放6个SK40/BT40/CAT40刀柄的储放架/Shelf to hold 6 SK40/BT40/CAT40 holders	84.805.07.041
可存放6个SK40/BT40/CAT40刀柄的储放架/Shelf to hold 12 SK40/BT40/CAT40 holders	84.805.07.042
可储放4个SK50/BT50/CAT50刀柄的储放架/Shelf to hold 4 SK50/BT50/CAT50 holders	84.805.07.050
可储放5个SK50/BT50/CAT50刀柄的储放架/Shelf to hold 5 SK50/BT50/CAT50 holders	84.805.07.051
<b>HSK储放架/Shelf HSK</b>	
可储放16个HSK-A/C/E32刀柄的储放架/Shelf to hold 16 HSK-A/C/E 32 holders	84.805.07.132
可储放16个HSK-A/C/E40刀柄的储放架/Shelf to hold 16 HSK-A/C/E 40 holders	84.805.07.140
可储放4个HSK-A/C/E40刀柄的储放架/Shelf to hold 4 HSK-A/C/E 40 holders	84.805.07.141
可储放12个HSK-A/C/E50刀柄的储放架/Shelf to hold 12 HSK-A/C/E 50 holders	84.805.07.150
可储放4个HSK-A/C/E63刀柄的储放架/Shelf to hold 4 HSK-A/C/E 63 holders	84.805.07.163
可储放6个HSK-A/C/E63刀柄的储放架/Shelf to hold 6 HSK-A/C/E 63 holders	84.805.07.164
可储放12个HSK-A/C/E63刀柄的储放架/Shelf to hold 12 HSK-A/C/E 63 holders	84.805.07.165
可储放5个HSK-A/C/E80刀柄的储放架/Shelf to hold 5 HSK-A/C/E 80 holders	84.805.07.181
可储放4个HSK-A/C/E100刀柄的储放架/Shelf to hold 4 HSK-A/C/E 100 holders	84.805.07.110
可储放5个HSK-A/C/E100刀柄的储放架/Shelf to hold 5 HSK-A/C/E 100 holders	84.805.07.111
可储放4个HSK-A/C/E125刀柄的储放架/Shelf to hold 4 HSK-A/C/E 125 holders	84.805.07.125
<b>其余类型储放架/Other Shelves</b>	
可存储12个PSC 32刀柄的储物架/Shelf to hold 12 PSC 32 holders	84.805.07.230
可存储12个PSC 40刀柄的储物架/Shelf to hold 12 PSC 40 holders	84.805.07.240
可存储12个PSC 50刀柄的储物架/Shelf to hold 12 PSC 50 holders	84.805.07.250
可存储6个PSC 63刀柄的储物架/Shelf to hold 6 PSC 63 holders	84.805.07.260
可存放4个VDI25刀柄的储物架/Shelf to hold 4 VDI25 holders	84.805.07.325
可存放4个VDI40刀柄的储物架/Shelf to hold 4 VDI40 holders	84.805.07.340
可存储5个牧野F-80刀柄的储物架/Shelf to hold 5 Makino F-80 holders	84.805.07.680
可存储3个动平衡机转换套的储放架/Shelf to hold 3 balancing adapter	84.805.07.401
超宽储物架/Shelf without plain (extra wide)	84.805.07.801

## 装配工作台 ASSEMBLY STATION

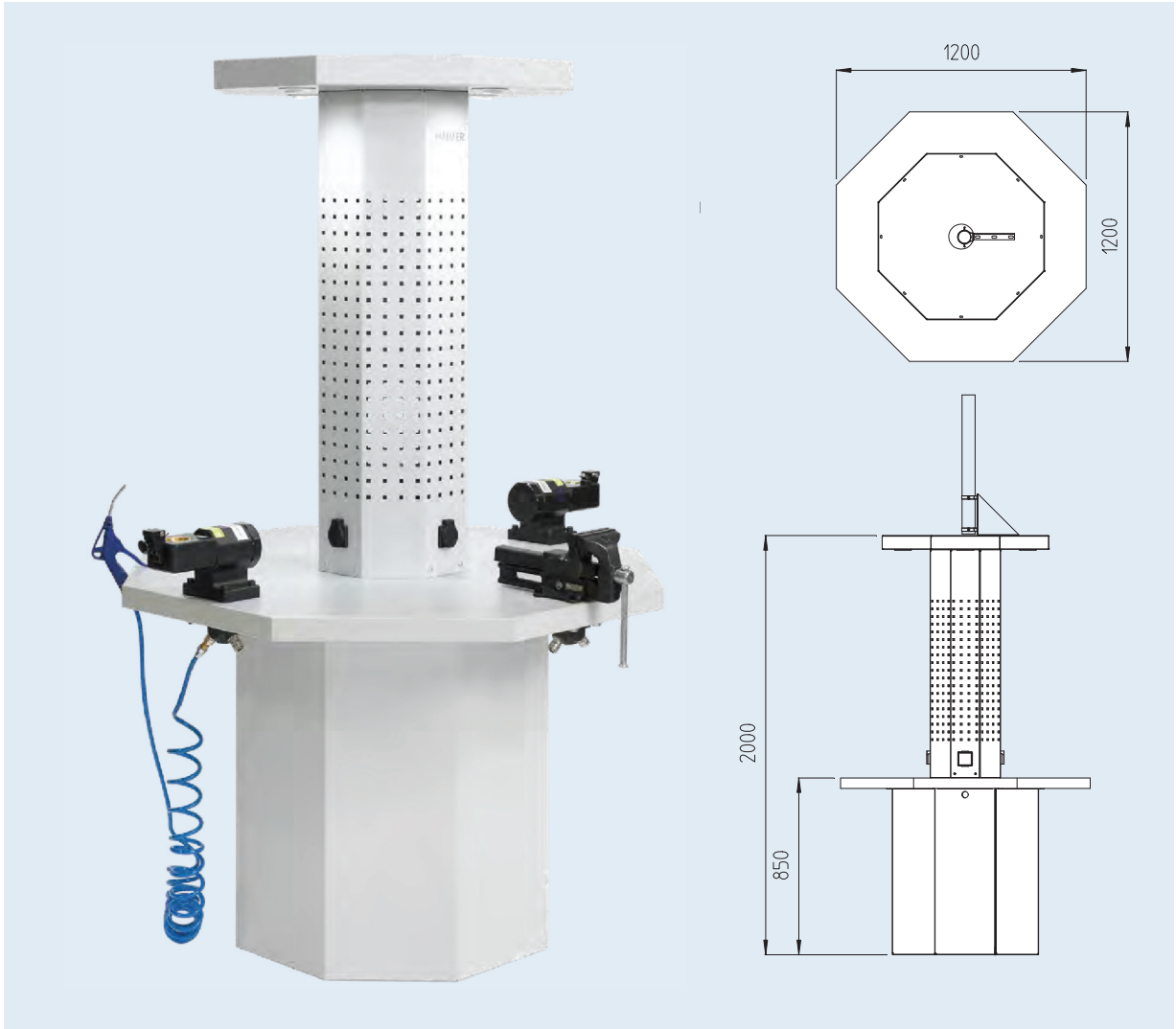

### 用途:

- 工作区域360°
- 配置了3个230V插座以及4组LED灯座的含开孔墙的中心圆柱
- 可以放置在加工中心附近或者直接放置在装配工作室, 便于进行装配工作, 节省空间。
- 可装配重物

### 发货时包含:

- 4个双头的压缩空气口
- 4组LED灯座

### Use:

- 360° accessible assembly area
- Middle column with perforated tin wall equipped with 3 x 230 V sockets and 4 LED spots
- The assembly station is perfectly suited for a peripheral, space-saving placement next to the machining center or centrally in the tool assembly room.
- Heavy Duty workplace

### Delivery includes:

- 4 double compressed air connections
- 4 LED lighting spots

描述/Description

装配工作台/Assembly station

订货号/Order No.

84.803.00.3

## 装配工作台-附件 ASSEMBLY STATION – ACCESSORIES

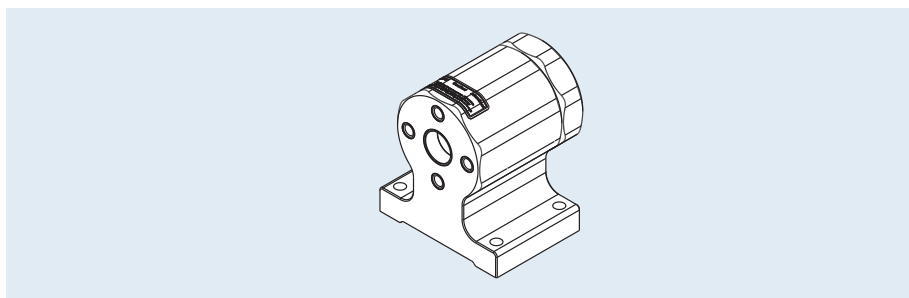

### 锁刀座:

- 用很小的锁紧力进行可靠的刀具安装
- 适于不同锥柄的快换功能-无附加工具
- 刀具安装安全, 无风险
- 弹性锁紧螺栓
- 机械安全销
- 更符合人体工学的锁刀结构
- 可以更换的铜制内衬套, 更好的保护刀柄锥柄表面
- 所需空间140\*100mm

### Tool Clamp – Tool-assembly device:

- Secure tool assembly with minimal physical effort
- Quick-change function for different taper interfaces – without additional tools
- Accident-free assembly of cutting tools
- Elastic locking bolt
- Mechanical security pin
- Better tool clamping thanks to optimum ergonomics
- Replaceable brass inserts protect the taper surface
- Required space 140 x 100 mm



锁刀座本体/Tool Clamp

锁刀座本体, 不含刀具夹持器, 含有4\*90°定位销  
Tool Clamp – without tool holder, 4 x 90° indexable

订货号/Order No.

84.700.00

刀具夹持器SK/Tool holder SK (DIN/MAS-BT/CAT)

订货号/Order No.

类型/Type

84.701.30

SK/BT 30

84.701.40

SK/BT 40

84.701.50

SK/BT 50

刀具夹持器 HSK-A/Tool holder HSK-A (DIN 69893/1)

订货号/Order No.

类型/Type

84.702.40

HSK-A40

84.702.50

HSK-A50

84.702.63

HSK-A63

84.702.80

HSK-A80

84.702.10

HSK-A100

刀具夹持器 HSK-C/HSK-E/Tool holder HSK-C/HSK-E (DIN 69893/1)

订货号/Order No.

类型/Type

84.703.25

HSK-C/E25

84.703.32

HSK-C/E32

84.703.40

HSK-C/E40

84.703.50

HSK-C/E50

84.703.63

HSK-C/E63

84.703.80

HSK-C/E80

刀具夹持器 HSK-F/Tool holder HSK-F

订货号/Order No.

类型/Type

84.704.63.M

HSK-F63 MAKINO

84.704.80.M

HSK-F80 MAKINO

刀具夹持器 PSC/Tool holder PSC

订货号/Order No.

类型/Type

84.705.30

PSC 32

84.705.40

PSC 40

84.705.50

PSC 50

84.705.60

PSC 63

刀具夹持器 KM4X100/Tool holder KM4X100

订货号/Order No.

类型/Type

84.706.4X.100

KM4X

工具钳/Vice

订货号/Order No.

84.810.22



刀具夹持器SK  
Tool holder SK



工具钳  
Vice



## 连接件 CONNECTION PARTS

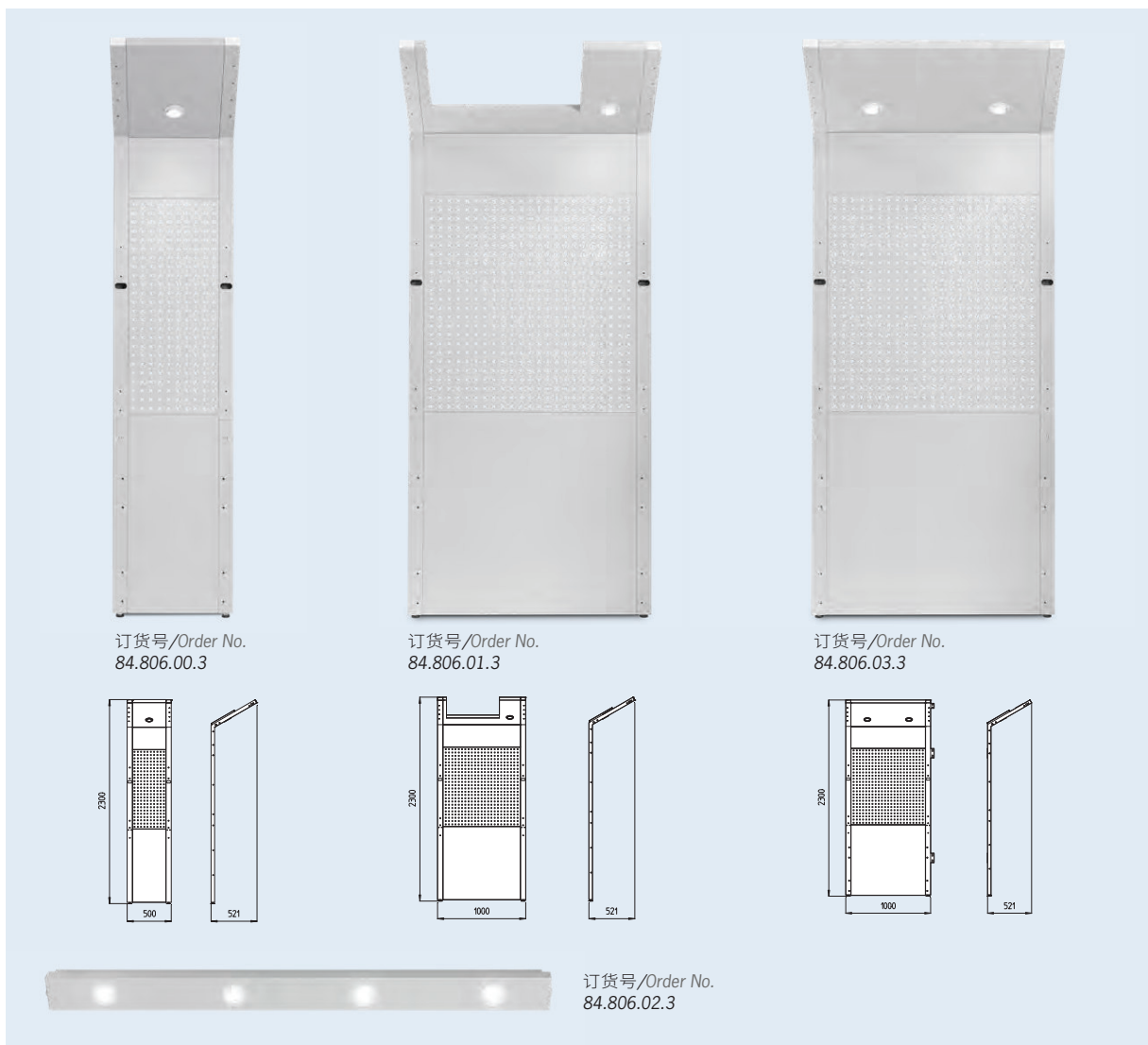

### 用途:

- 用以连接其他部分的连接单元
- 均配置了灯座及开孔背墙

### Use:

- Intermediate segment in order to connect the individual modules
- Each intermediate segment is equipped with a perforated wall and lighting spots

描述/Description	订货号/Order No.
连接件/Connection part	
50cm宽连接件,带一个LED灯座以及多孔板/Connection part 50 cm wide with 1 LED spot and perforated plate	84.806.00.3
100cm连接件,带2个LED灯座,适用于TD Preset的多孔板 Connection part 100 cm wide with 1 LED spot and perforated plate for TD Preset	84.806.01.3
100cm宽连接件,带2个LED灯座以及多孔板/Connection part 100 cm wide with 2 LED spots and perforated plate	84.806.03.3
适用于超级增强型热缩机的顶层灯带/Light Bar superstructure for Power Clamp Premium Plus	84.806.02.3

## 刀柄运输车 TOOL HOLDER CART

### 刀柄运输车-基架 Tool holder cart – base frame

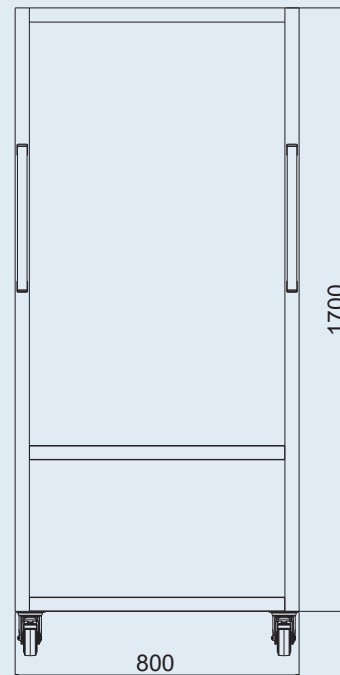
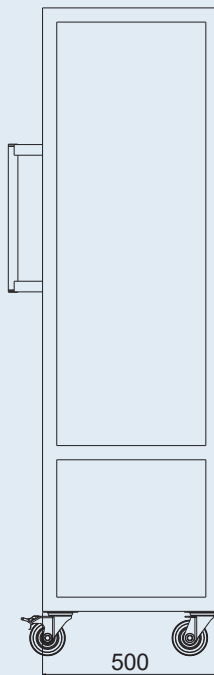

#### 用途:

- 四轮标准框架,带刹车及2个把手
- 根据预选的配置单独发运
- 安全的运输刀具及配件至机床
- 机床区域更高组织化
- 刀柄排列比普通商业用刀柄运输车更整齐和清晰
- 适用于砂轮杆的工具车(通过标准尺寸的刀具夹持器)
- 适用于运输机床上使用的各种工具:内六角扳手、外六角扳手、钩扳手、橡胶锤和校准棒等
- 适用于运输动平衡机的一些附件,比如转换套、HG筒夹等。

#### Use:

- Standard frame with four wheels, brakes and two handles
- Individual delivery by using a predefined modular system
- Safe transportation of tools and accessories to the machine
- More organization in the machine area
- More clearly arranged than commercially available tool carts
- Tool cart for grinding wheel adapters (held using standard size grip-per grooves)
- Tool cart works for any tool used at the machine, no matter if it has an internal hexagon, external hexagon, hook wrench, rubber mallet, gauge etc.
- Tool cart for balancing machine accessories to hold balancing adapt-ers, HG collets etc.

#### 描述/Description

刀柄运输车/Tool holder cart

#### 订货号/Order No.

84.808.00.3

# 刀柄运输车 TOOL HOLDER CART

刀柄运输车-产品应用范例  
Tool holder cart – Configuration examples



## 刀柄运输车结构图 TOOL HOLDER CART DESIGN

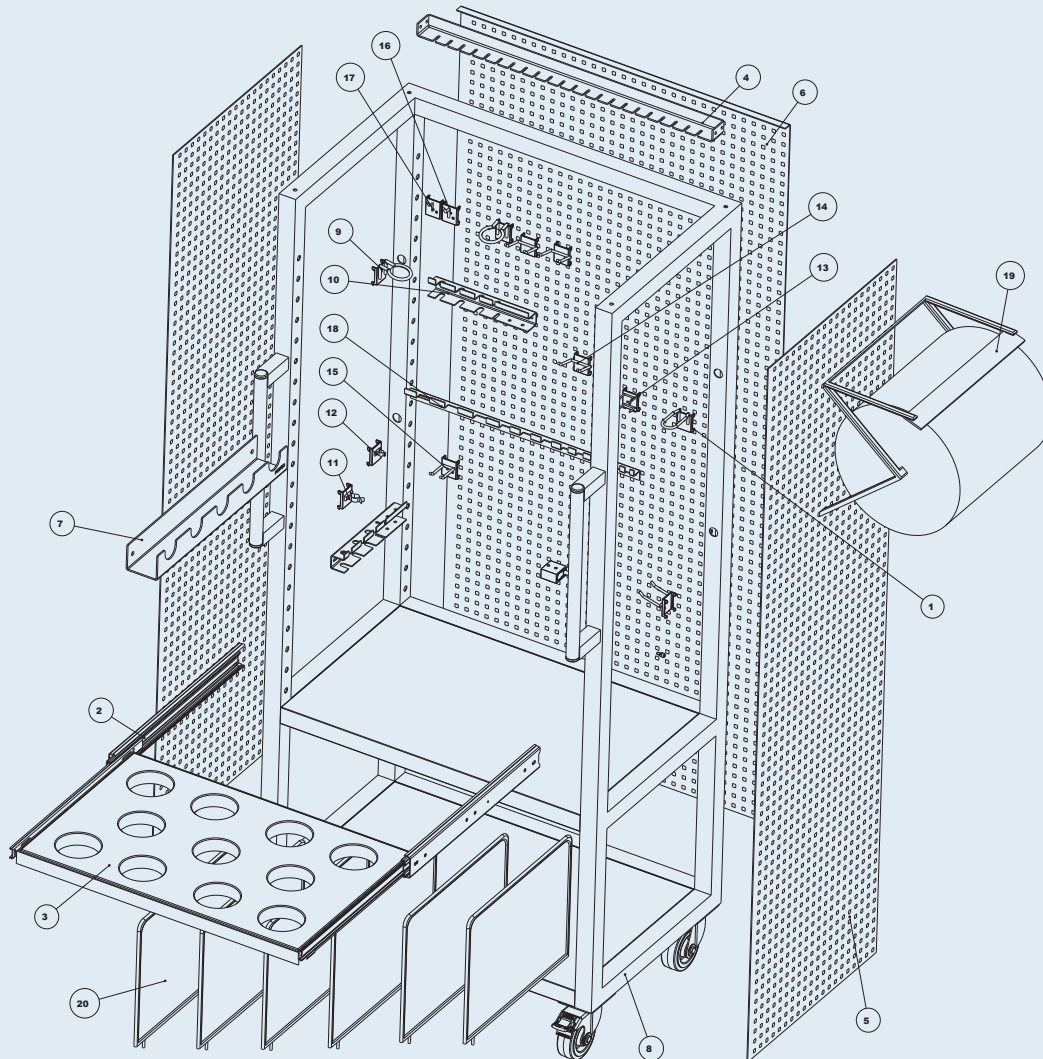

1	Pliers holder 7 mm x 40 mm	11	Tool clip $\varnothing$ 25 mm
2	Drawer slide	12	Tool clip $\varnothing$ 12 mm
3	Shelf for balancing adapters	13	Articulated wrench hook (28 mm x $\varnothing$ 3 mm)
4	Shelf for collets	14	Double hook (50 mm x 40 mm)
5	Perforated plate long version (side)	15	Double hook (55 mm x 25 mm)
6	Perforated plate long version (back)	16	Hook (24 mm x $\varnothing$ 5)
7	Shelf for tool holders	17	Hook (22 mm x $\varnothing$ 3)
8	Base cart	18	Screw wrench holder
9	Ring holder (inside $\varnothing$ 40 mm)	19	Paper dispenser (without paper roll)
10	Screwdriver holder	20	Partition wall

## 刀柄运输车 - 附件 TOOL HOLDER CART - ACCESSORIES 储物架/SHELVES

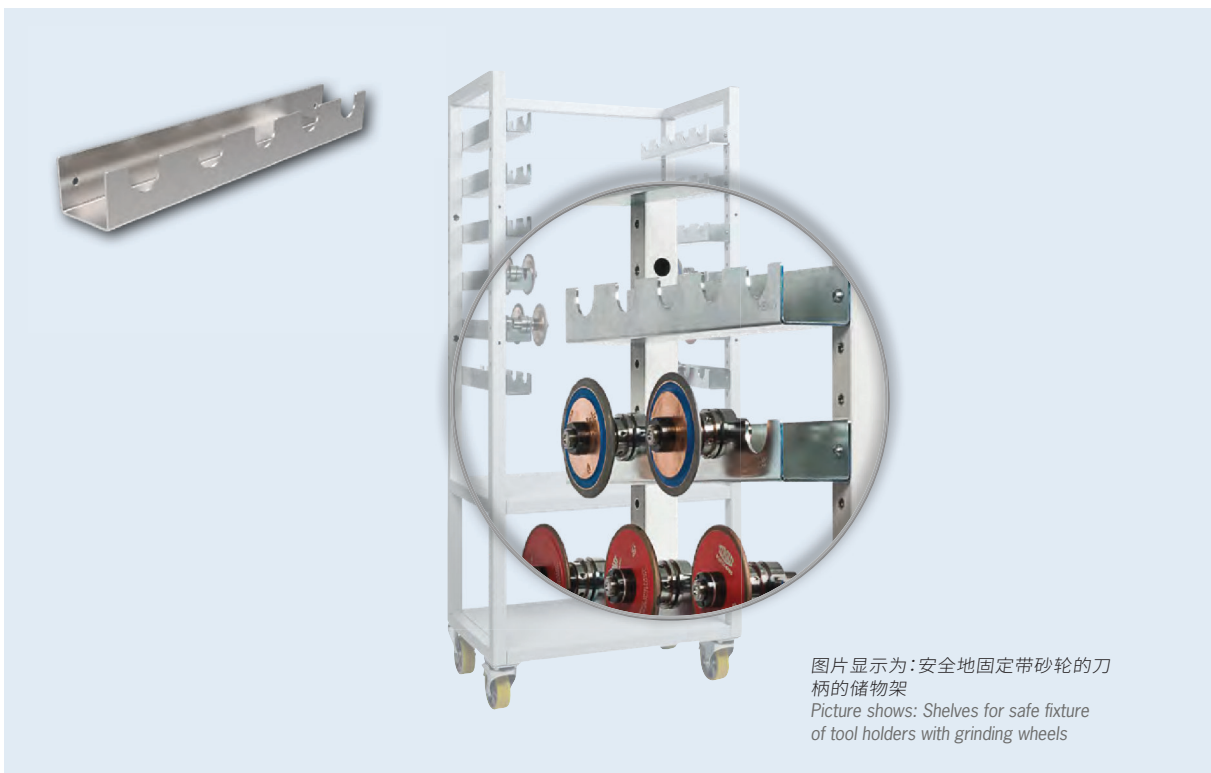
**用途：**

- 用于安全放置刀柄的货架

**Use:**

- Shelves for safe tool holder fixture

描述/Description	订货号/Order No.
刀柄运输车储物架/Shelves for toolholder cart	
标准8片装, 无类型/8 pieces without plain	84.808.00.01
SK接口储物架/Shelves SK	
SK30: 每片5个孔位, 共8片/8 pcs. for 5 pcs. toolholders each	84.808.00.030
SK40: 每片5个孔位, 共8片/8 pcs. for 5 pcs. toolholders each	84.808.00.040
SK50: 每片4个孔位, 共8片/8 pcs. for 4 pcs. toolholders each	84.808.00.050
BT接口储物架/Shelves BT	
BT30: 每片5个孔位, 共8片/8 pcs. for 5 pcs. toolholders each	84.808.00.130
BT40: 每片4个孔位, 共8片/8 pcs. for 4 pcs. toolholders each	84.808.00.140
BT50: 每片4个孔位, 共8片/8 pcs. for 4 pcs. toolholders each	84.808.00.150
CAT接口储物架/Shelves CAT	
CAT40: 每片4个孔位, 共8片/8 pcs. for 4 pcs. toolholders each	84.808.00.240
CAT50: 每片4个孔位, 共8片/8 pcs. for 4 pcs. toolholders each	84.808.00.250
HSK接口储物架/Shelves HSK	
HSK-A/E 32: 每片5个孔位, 共8片/8 pcs. for 5 pcs. toolholders each	84.808.00.332
HSK-A/E/F 40: 每片5个孔位, 共8片/8 pcs. for 5 pcs. toolholders each	84.808.00.340
HSK-A/E/F 50: 每片5个孔位, 共8片/8 pcs. for 5 pcs. toolholders each	84.808.00.350
HSK-A/E/F 63: 每片5个孔位, 共8片/8 pcs. for 5 pcs. toolholders each	84.808.00.363
HSK-A/E/F 80: 每片4个孔位, 共8片/8 pcs. for 4 pcs. toolholders each	84.808.00.380
HSK-A/E/F 100: 每片4个孔位, 共8片/8 pcs. for 4 pcs. toolholders each	84.808.00.310
PSC63接口储物架/Shelves PSC 63	
PSC63: 每片5个孔位, 共8片/8 pcs. for 5 pcs. toolholders each	84.808.00.460

## 刀柄运输车 - 附件 TOOL HOLDER CART - ACCESSORIES



基架  
Base frame

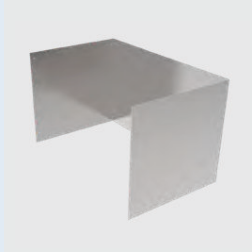

金属盖板  
Metal cover plate



动平衡机转换套用抽屉插件  
Drawer insert for balancing  
adapters

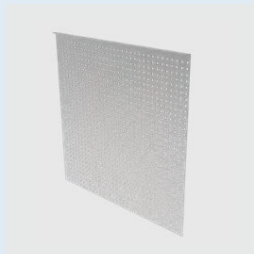

开孔板  
Perforated plate

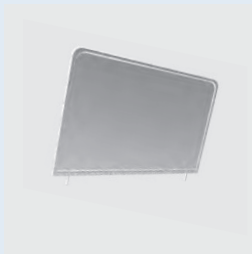

间隔墙  
Partition wall



擦拭纸辊筒  
Paper dispenser

描述/Description	订货号/Order No.
<b>开孔板/Perforated plate</b>	
背面-长边/back long	140056-0013
背面-短边/back short	140056-0009
侧面-长边/side long	140056-0014
侧面-短边/side short	140056-0010
<b>金属盖板/Metal cover plate</b>	
长型/long	140056-0008
短型/short	140956-0005
<b>动平衡机转换套用抽屉插件/Drawer insert for balancing adapters</b>	
角板框架/Angle plate frame	140056-0006
货架/Shelf	140056-0007
抽屉滑槽/Drawer slide	140956-0006
<b>间隔墙/Partition wall</b>	
间隔墙 (6底板)/Partition wall (6 piece bottom plate)	140056-0015
<b>擦拭纸辊筒/Paper dispenser</b>	
不带纸辊的擦拭纸辊筒/Paper dispenser without paper roll	84.810.23

## 开孔板 - 附件

### PERFORATED PLATE - ACCESSORIES

#### 下颚型支架/HOLDER JOWLS

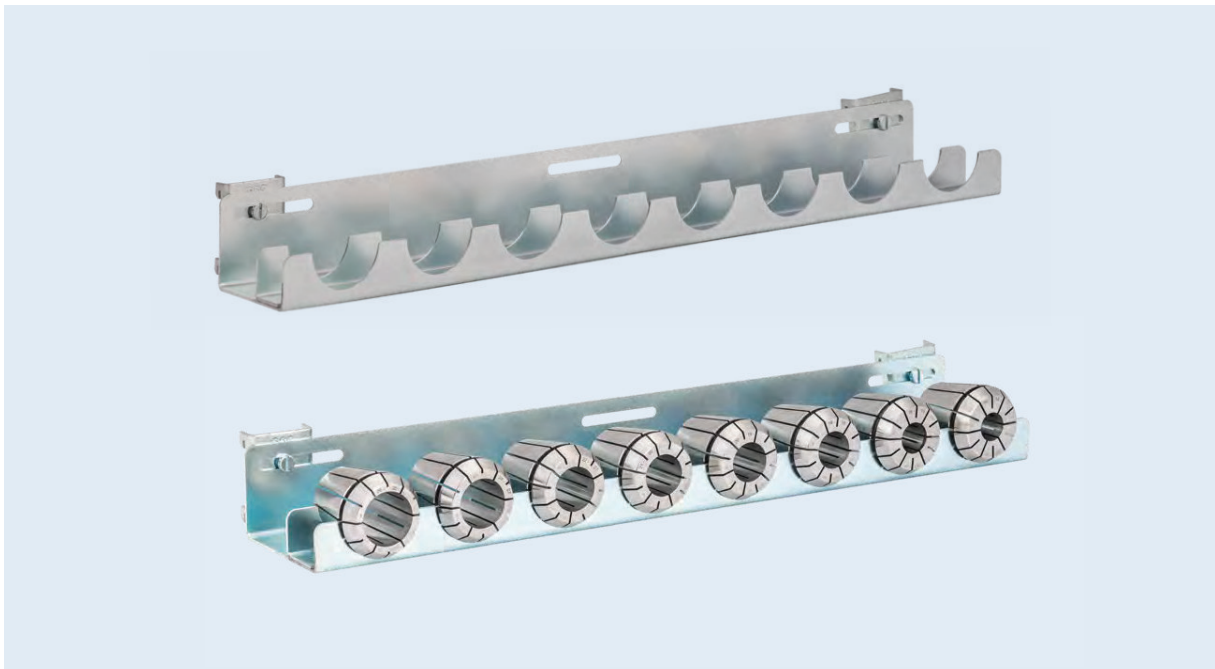
**用途:**

- 用以存储筒夹的下颚型支架

**Use:**

- Holder jowls for secure storage of collets

描述/Description	订货号/Order No.
<b>ER筒夹用下颚型支架/Holder Jowls for ER Collets</b>	
ER11筒夹用下颚型支架,可储存21个/Holder jowl for 21 pcs. ER11 collets	84.809.011
ER16筒夹及ER16强力筒夹用下颚型支架,可储存17个/Holder jowl for 17 pcs. ER16 Collets and ER16 Power Collets	84.809.016
ER20筒夹用下颚型支架,可储存12个/Holder jowl for 12 pcs. ER20 collets	84.809.020
ER25筒夹及ER25强力筒夹用下颚型支架,可储存12个/Holder jowl for 12 pcs. ER25 Collets and ER25 Power Collets	84.809.025
ER32筒夹及ER32强力筒夹用下颚型支架,可储存11个/Holder jowl for 11 pcs. ER32 Collets and ER32 Power Collets	84.809.032
ER40筒夹用下颚型支架,可储存8个/Holder jowl for 8 pcs. ER40 collets	84.809.040
<b>OZ筒夹用下颚型支架/Holder Jowls for OZ Collets</b>	
OZΦ2-16mm筒夹用下颚型支架,可储存15个/Holder jowl for 15 pcs. OZ collets Ø 2-16 mm	84.809.116
OZΦ2-25mm筒夹用下颚型支架,可储存11个/Holder jowl for 11 pcs. OZ collets Ø 2-25 mm	84.809.125
OZΦ6-32mm筒夹用下颚型支架,可储存8个/Holder jowl for 8 pcs. OZ collets Ø 6-32 mm	84.809.132
OZΦ8-40mm筒夹用下颚型支架,可储存7个/Holder jowl for 7 pcs. OZ collets Ø 8-40 mm	84.809.140
OZΦ4-50mm筒夹用下颚型支架,可储存6个/Holder jowl for 6 pcs. OZ collets Ø 4-50 mm	84.809.150
<b>HG筒夹用下颚型支架/Holder Jowls for HG Collets</b>	
HG01筒夹用下颚型支架,可储存16个/Holder jowl for 16 pcs. HG01 collets	84.809.201
HG02筒夹用下颚型支架,可储存16个/Holder jowl for 16 pcs. HG02 collets	84.809.202
HG03筒夹用下颚型支架,可储存13个/Holder jowl for 13 pcs. HG03 collets	84.809.203

## 附件 ACCESSORIES

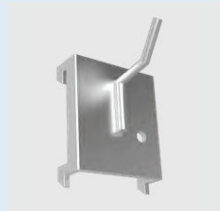

单挂钩  
Hook single



双挂钩  
Hook double



钢领座  
Ring holder

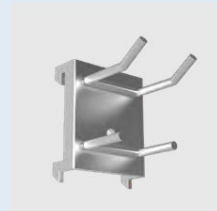

扳手挂钩  
Articulated wrench hook



工具夹  
Tool clip

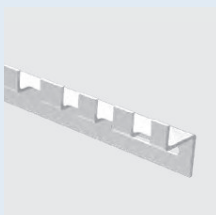

HG筒夹固定架  
HG Collet fixture

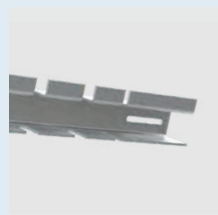

螺丝刀支架  
Screwdriver holder



擦拭纸辊筒  
Paper dispenser

描述/Description	订货号/Order No.
<b>开孔板附件/Accessories for perforated plate</b>	
Φ3mm单挂钩/Hook single Ø 3 mm	84.810.01
Φ5mm单挂钩/Hook single Ø 5 mm	84.810.02
55*25mm双挂钩/Hook double 55 x 25 mm	84.810.03
50*40mm双挂钩/Hook double 50 x 40 mm	84.810.04
扳手挂钩/Articulated wrench hook	84.810.05
Φ12mm工具夹/Tool clip Ø 12 mm	84.810.06
Φ15mm工具夹/Tool clip Ø 15 mm	84.810.07
钢领座/Ring holder	84.810.08
底座支架/Base holder	84.810.09
螺丝刀支架, 6支用/Screwdriver holder for 6 screwdrivers	84.810.10
螺丝刀支架, 12支用/Wrenchholder for 12 wrenches	84.810.11
缠绕膜支架/Holder for clear film	84.810.12
物品存放处(440 mm x 300 mm x 100 mm)/Storage place (440 mm x 300 mm x 100 mm)	84.810.13.3
钳子架/Pliers holder	84.810.16
擦拭纸辊筒 (不带纸辊)/Paper dispenser (without paper roll)	84.810.23
HG筒夹固定架/HG Collet fixture	140056-0005
<b>电气附件/Accessories for electronics</b>	
带变压器的电源连接/Electronic connection set with transformer	84.811.00
变压器/Transformer	140051-0108
灯/Lamp	140051-0111
灯用插座/Lamp socket	140051-0110
电缆铺设管组 (电/气)/Pipe set for cable laying (Electronic/air)	84.811.10
可根据要求提供特定国家的电源插座/Country-specific power outlets available on request!	
<b>启动套装/Starter Sets</b>	
迷你启动套装/Starterset Mini	84.810.17
中型启动套装/Starterset Medium	84.810.17.1
大型启动套装/Starterset Large	84.810.17.2
<b>工作垫/Work pads</b>	
600 mm x 1500 mm工作台面工作垫 (透明, PVC材质) Work pad for work bench 600 mm x 1500 mm (transparent, soft PVC)	84.810.18
角单元用工作垫 (透明, PVC材质)/Work pad for corner module (transparent, soft PVC)	84.810.19
工作垫 690mm x 500mm (透明, PVC材质)/Work pad 690 mm x 500 mm (transparent, soft PVC)	84.810.20
装配工作台面工作垫 (透明, PVC材质)/Work pad for assembly station (transparent, soft PVC)	84.810.29